

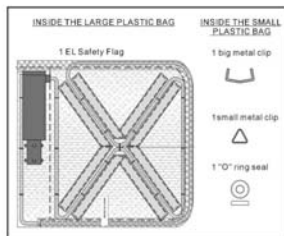

EL Fibre Safety Flag Installations Instructions

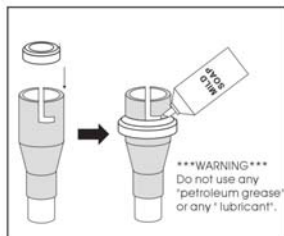

- 1) Open package and check inside the large plastic bag containing the EL Safety Flag for a second smaller bag which contains 2 metal clips and 1 "O" Ring seal.



- 2) Open the small plastic package and take out the "O" Ring seal and install the seal over the light socket of the fiberglass shaft. It is recommended to use a mild soap to help with the installation on the "O" Ring seal.

****Do not use any petroleum grease or any lubricant which may attack the rubber seal "O" Ring and damage it.

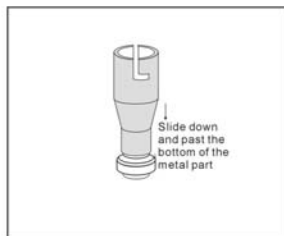

- 3) Slide the "O" Ring Seal past the bottom of the Metal part of the Light Socket.

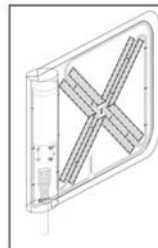

- 4) Install the EL Safety Flag through the opening of the flag onto the Metal Light Socket.

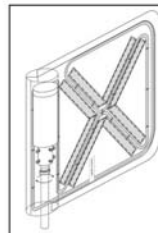

Gently, Turn the Flag unit you can feel that the Inverter Base has connected with the fiberglass shaft Light Socket and you can feel that base has "locked in"

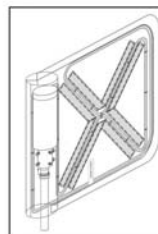

- 5) Slide the "O" Ring up the Light Socket and push into the Inverter Housing to create a perfect sealing between the Light Socket and the Inverter Housing.

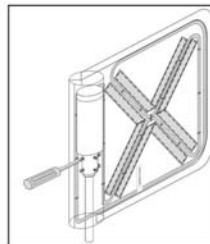

- 6) Tighten the 8 screws to secure the Housing onto the Shaft.